



888 s andrews avenue, suite 300  
Fort Lauderdale FL. 33316  
office: 954.224.0432  
LA# 6666983

DESIGNED DRAWN CHECKED

## PLANT SCHEDULE

SYMBOL	CODE	QTY	BOTANICAL NAME	COMMON NAME
TREES				
	CD	1	Cocoloba diversifolia	Pigeon Plum
	CE	10	Conocarpus erectus	Green Buttonwood
	CS2	4	Conocarpus erectus 'Sericeus'	Silver Buttonwood
	CS	7	Cordia sebestena	Orange Geiger Tree
	PM	1	Phoenix dactylifera 'Medjool'	Medjool Date Palm
	SS	10	Sabal palmetto	Cabbage Palmetto
	TR	6	Thrinax radiata	Florida Thatch Palm
SHRUBS				
	PB	8	Plumeria pudica 'Bridal Bouquet'	Frangipani
	SM	24	Suriana maritima	Bay Cedar
	YE	9	Yucca elephantipes	Soft Spine Yucca
SHRUB AREAS				
	AD	152	Alternanthera dentata	Little Ruby
	CH	80	Chrysobalanus icaco	Cocoplum
	CG	163	Clusia guttifera	Small leaf Clusia
	EH	20	Equisetum hyemale	Horsetail
	EL	315	Ernodea littoralis	Golden Creeper
	FG	46	Ficus microcarpa 'Green Island'	Green Island Ficus
	HD	349 sf	Helianthus debilis	Dune Sunflower
	HL	99	Hymenocallis latifolia	Spider Lily
	MC	180	Muhlenbergia capillaris	Pink Muhly
	PD	212	Panicum amarum	Bitter Panicgrass
	PG	202	Portulaca grandiflora	Purslane
	US	3,131	Uniola paniculata	Sea Oats
	ZP	118	Zamia pumila	Coontie
GROUND COVERS				
	PV	12,167 sf	Paspalum vaginatum	Seashore Paspalum

SEE SHEET L-2.1 FOR COMPLETE PLANT LIST SPECIFICATION

ALL HEDGES ABUTTING CITY RIGHTS OF WAY ARE MAINTAINED AT A HEIGHT NO GREATER THAN 24"

## EXISTING TREE KEY

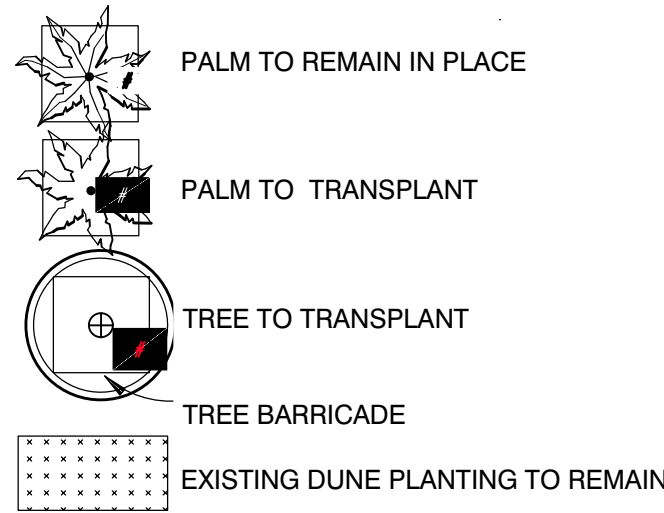

## REVISIONS

DATE: 1/24/2024  
COMM: 22019

580 BRINY AVE.

580 BRINY AVE.  
POMPANO BEACH, FL

Natalia Barranco  
c=US, sn=Barranco,  
givenName=Natalia, email=natalia@b-  
rla.com, cn=Natalia Barranco  
2024.06.30 19:19:54 -04'00'

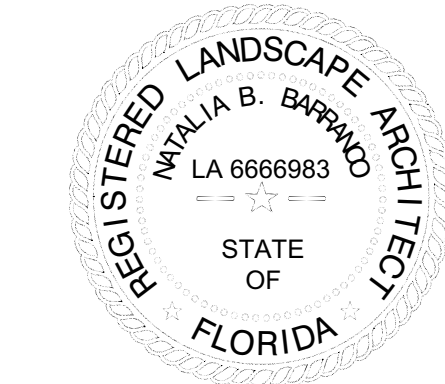

LANDSCAPE PLAN  
SITE PLAN APPROVAL

L-2.0

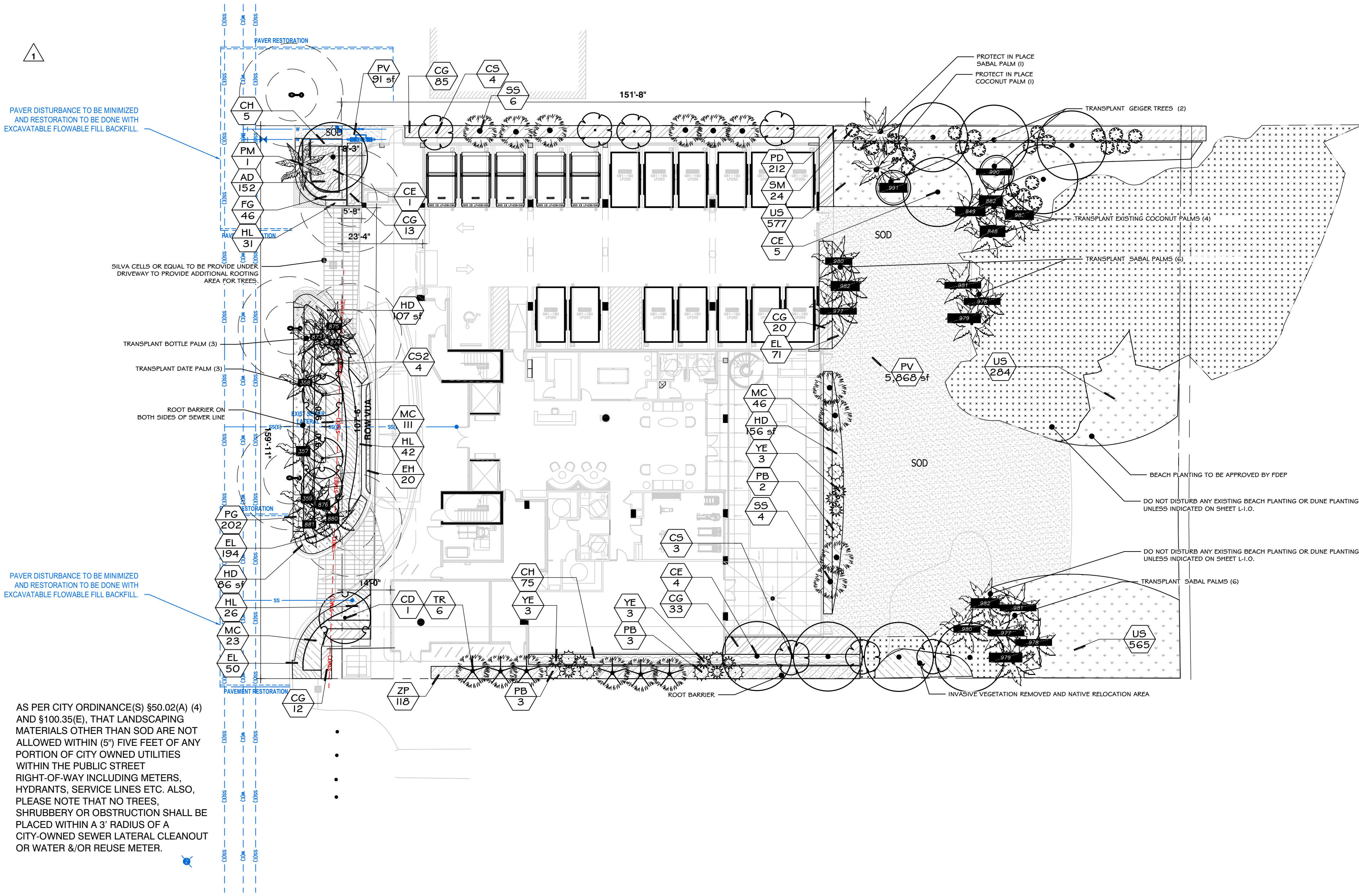

## LANDSCAPE PLAN

SCALE: 1" = 20'-0"

